

Recd. dt. 08/05/2011

SOLD & SERVICED BY



KRUTAM
ENTERPRISES

64/B, G.I.D.C., Makarpura, Baroda-10.
Ph.(0265) 2640767 / 3047424 Fax : (0265) 2651828
E-mail : krutam@krutam.com
krutam.nirmal@gmail.com
web site : www.krutam.com

FOUNDATION BOLT DETAILS AS PER IS - 5624

DIM	TYPE B1	TYPE B2
	AM 20	AM 12
d	20	12
b	50	30
a	60	36
c	105	65
l	300	250

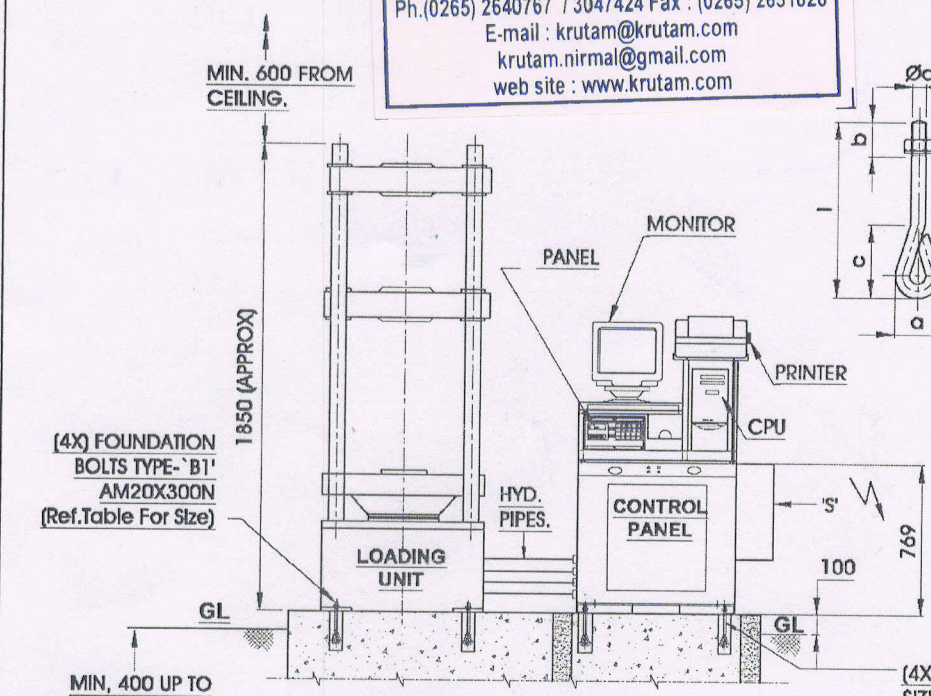

FRONT VIEW OF MACHINE

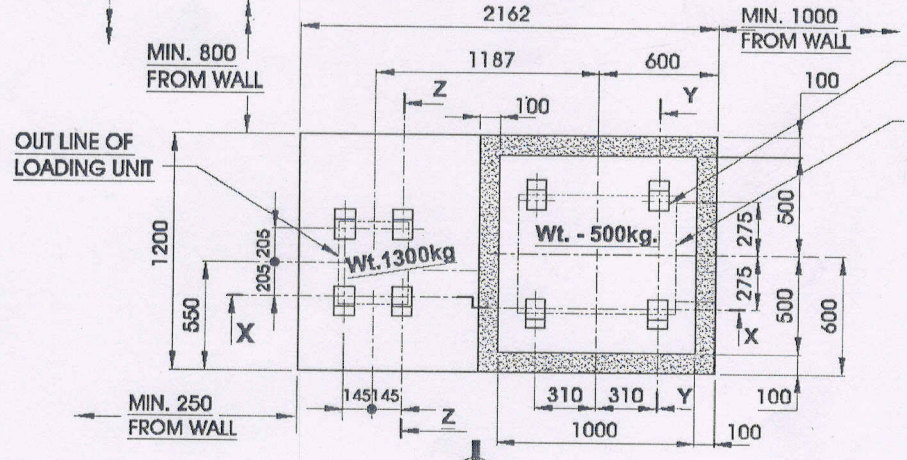

(8X) 100 X 100 X 300 DEEP POCKETS FOR FOUNDATION BOLTS.

OUT LINE OF CONTROL PANEL

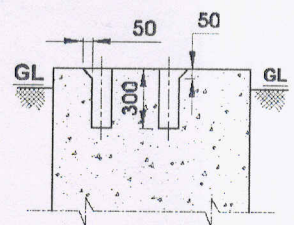

SECTION Z-Z

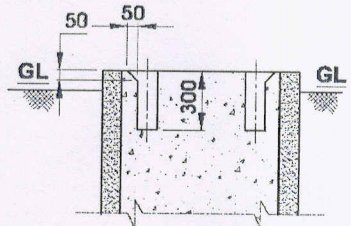

SECTION Y-Y

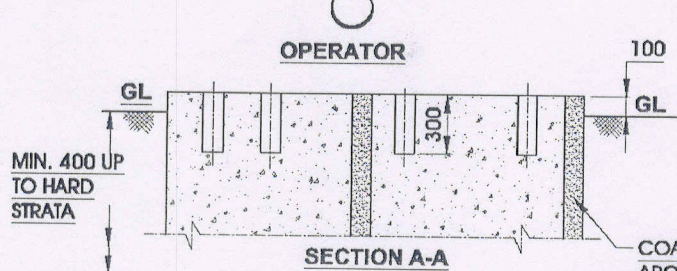

SECTION A-A

- NOTE :-**
- ALL DIMENSIONS ARE IN mm.
 - 'S' ELECTRIC SUPPLY POINT LOCATION. (3 PHASE, 440 V, 50 CYCLE, A.C.)

*** ELECTRONIC AND COMPUTERISED UNIVERSAL TESTING MACHINE *
FOUNDATION PLAN**

MODEL - TUE-C-200

DRN :- PRANOTI, DATE :- 07.08.2010, CHK :- Y.V.Kulkarni.

Fine Spavy Associates And Engineers
Pvt. Ltd. C-45-2 M.I.D.C. Miraj.

